

C158 246

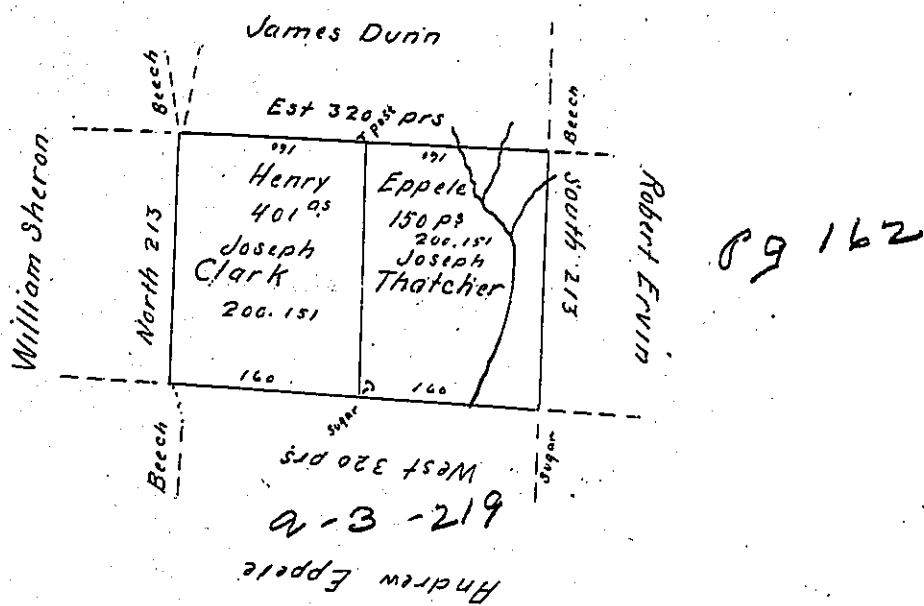

Situate on the west Side of French Creek in Allegheny County containing 401 Acres 150 prs and allowance of Six prs Cent for Roads &c. Resurvey'd the 12<sup>th</sup> of July 1799. In pursuance of a warrant of 400<sup>as</sup> granted to Henry Eppeler bearing date the 30<sup>th</sup> May 1792 for It being the same tract of Land which was Surveyed the 6<sup>th</sup> November 1794 for William Dunn on his Improvement dated 5<sup>th</sup> November 1794.

Crawford County S.S.

I do Certify that the above is a true Copy <sup>of Survey as it stands</sup> ~~of the original~~ ~~now situate~~ ~~stated~~ ~~of Record~~ remaining in my office. Now Situate in follow field township Crawford County. Excepting the division which was Surveyed and marked between Joseph Thatcher and Joseph Clark the 4<sup>th</sup> July 1817.

To Richard T. Leech, Surveyer genl.

James Herrington D.P. Sr.

IN TESTIMONY that the above is a copy of the original remaining on file in the Department of Internal Affairs of Pennsylvania, made conformably to an Act of Assembly approved the 16th day of February, 1833, I have hereunto set my Hand and caused the Seal of said Department to be affixed at Harrisburg, this first day of September 1904.

*Joseph P. Brown*  
Secretary of Internal Affairs.